



ASSEMBLY AND PARTS LIST MANUAL



RELIABELT CONVEYOR

20-12



www.meridianmfg.com

DECLARATION OF CONFORMITY

We the Manufacturer:

Meridian Manufacturing Inc.
PO Box 1996 2800 Pasqua Street North
Regina, Sk, Canada
S4P 3E1

Declare the Conveyors listed below conform to the 2006/42/EC Machinery
Directive

RELIABELT JUMP

The Meridian Reliabelt Conveyor Series
is designed for the movement of Grains and Cereals.

INTRODUCTION

CONGRATULATIONS

Congratulations on your choice of a Reliabelt Conveyor. This conveyor has been designed and manufactured to meet the exacting standards for such equipment in the agricultural industry and will keep your seed delivery system at optimum efficiency.

Safe, efficient, and trouble-free operation of your conveyor requires that you and anyone else who will be operating or maintaining the conveyor, read and understand the Safety, Operation, Maintenance, and Troubleshooting information contained within this manual.

This manual covers the operating procedures and maintenance of the conveyor designed by Meridian Manufacturing, Inc. Use the Table of Contents as a guide to locate required information.

INTENDED USE

This Conveyor is designed to elevate grain being dumped from a vehicle or container and deposited into another conveyor or container. It is not intended to convey any other product, such as fertilizer and canola.

OWNER/OPERATOR

It is the responsibility of the owner or operator to read this manual and to train all other operators before they start working with the conveyor. Follow all safety instructions exactly. Safety is everyone's business. By following recommended procedures, a safe working environment is provided for the operator, bystanders, and the area around the work site. Untrained operators are not qualified and must not operate the conveyor.

In addition to the design and configuration of the conveyor, hazard control and accident prevention are dependent upon the awareness, concern, prudence, and proper training of personnel involved in the operation, transport, maintenance, and storage of the conveyor. Follow all safety instructions as provided in this manual.

Keep this manual accessible for easy reference. Call your Meridian Manufacturing, Inc. dealer if you need assistance, information, or additional copies of the manuals.

The information, specifications, and illustrations in this manual are those in effect at the time of printing. We reserve the right to change specifications or design at any time without notice.

OWNERSHIP CHANGES

If any of the equipment associated with this conveyor changes ownership, then the new owner(s) must be given all applicable documentation associated with all the components/equipment of the site. The new owners need to notify the individual manufactures of the ownership changes so that updates to product or documentation can be forwarded to the new owner(s). This should be done even if the conveyor is out of warranty because many manufacturers supply update notifications as long as they have valid ownership information.

 **WARNING**

DO NOT use an entire assembly, or even a component of an assembly, for anything other than the manufacturer's original intended use. Not only is the warranty voided, but the component can fail in the unintended application creating a hazard to the conveyor and the personnel using that conveyor.

END OF LIFE DISPOSAL

The Reliabelt conveyors are designed for the specific purpose of conveying grain. When this conveyor is no longer capable of doing its designed purpose, it should be dismantled and scrapped. Do not use any materials or components from this conveyor for any other purpose.

REPORTING HAZARD

If any of the equipment associated with this conveyor appears to pose a hazard, then it is the duty of the individual to report it immediately. If the hazard is the conveyor, then the manufacturer and site manager must be notified. If the hazard is a process, then the site manager must be notified. Unreported hazards can lead to serious injury or death to personnel.

TABLE OF CONTENTS

GENERAL

- A1 Declaration Of Conformity
- A2 Introduction
- A4 Table Of Contents
- A5 Sign-Off Sheet

SPECIFICATIONS

- B1 Conveyor Nomenclature
- B2 Specifications

SETUP

- C1 Jump Packages
- C2 Axle and Wheels Assembly
- C3 Hitch Assembly
- C3 Intake Roller and Scraper Assembly
- C3 Discharge Roller Assembly
- C4 Belt Assembly
- C4 Pinch Roller Assembly
- C5 Intake Hopper Assembly
- C6 Crank Assembly
- C7 Engine and Drive Belt Assembly
- C8 Finished Assembly
- C9 Final Check and Testing

PARTS LIST

- D2 Hitch, Intake Roller, Casters and Scraper
- D3 Canvas, Hopper Hoops and Rubber Flashing
- D4 Axle, Wheels and Hubs, and Crank
- D5 Motor and Mount, Discharge and Roller
- D7 Parts Index

SPECIFICATIONS

- E1 Warranty

MERIDIAN EQUIPMENT SIGN-OFF SHEET

Meridian follows the general Safety Standards specified by the American Society of Agricultural Engineers (ASAE) and Occupational Safety and Health Administration (OSHA). Anyone who will be operating and/or maintaining the Meridian conveyor must read and clearly understand ALL Safety, Operating, and Maintenance information presented in this manual.

Do not allow anyone to operate this conveyor until such information has been reviewed. Annually review this information before the season start-up.

Make these periodic reviews of SAFETY and OPERATION a standard practice for all of your equipment. We believe an untrained operator is unqualified to operate this conveyor.

A sign-off sheet is provided for your recordkeeping to show that all personnel who will be working with the conveyor have read and understand the information in the Operator's Manual and have been instructed in the operation of the conveyor.

DATE	EMPLOYEE SIGNATURE	EMPLOYER SIGNATURE

CONVEYOR NOMENCLATURE

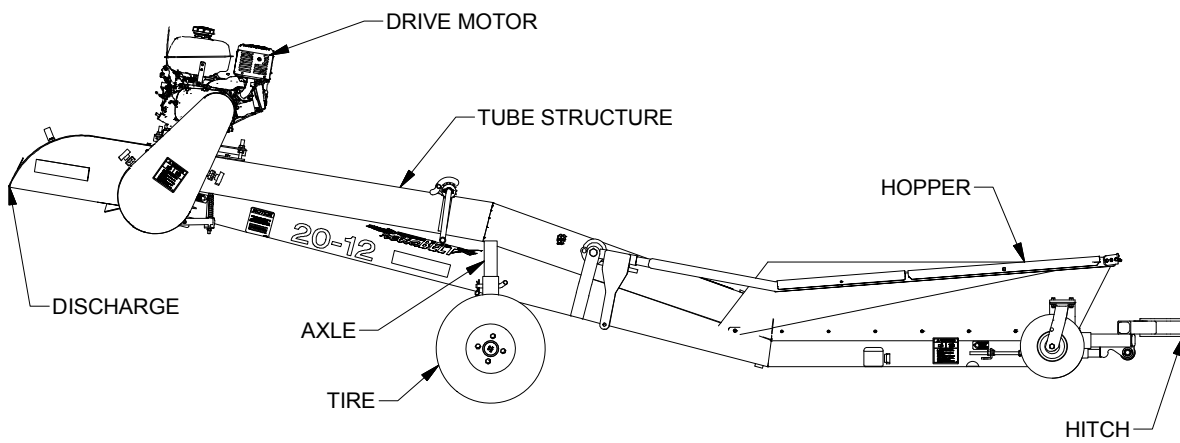
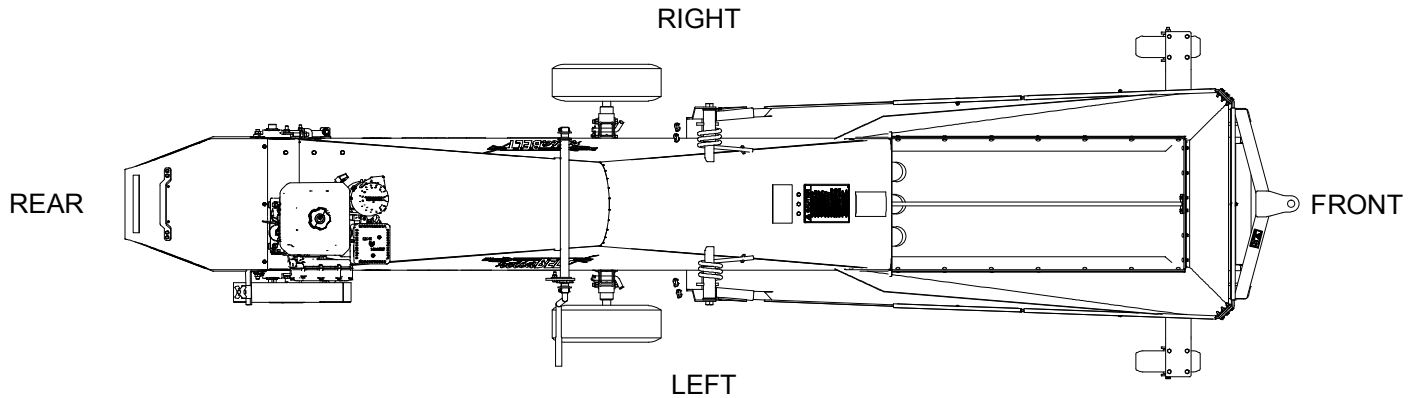

When standing at the hopper end facing toward the conveyor, the side to the left is considered the **Left Side**; the side to the right is considered the **Right Side**.

The end of the conveyor connected to a towing vehicle is the **Front**. The discharge or upper end of the conveyor is the back or **Rear**.

The **Tube Structure** is the largest structure of the conveyor. This structure guides the conveyor belt and keeps the grain from spilling from the belt.

The **Axle** attaches the wheels to the tube structure.

The **Drive Motor** is used to propel the conveyor belt. V-belts attach the drive motor to the conveyor belt drive roller.

The **Discharge** gathers the seed coming off the conveyor belt and directs it downward.

The **Hopper** is located at the front end of the conveyor and is where the grain is deposited from a transport vehicle. The hopper has a spring loaded bale that allows the canvas sides of the hopper to collapse if contacted by the dumping vehicle.

SPECIFICATIONS

OVERALL SPECIFICATIONS

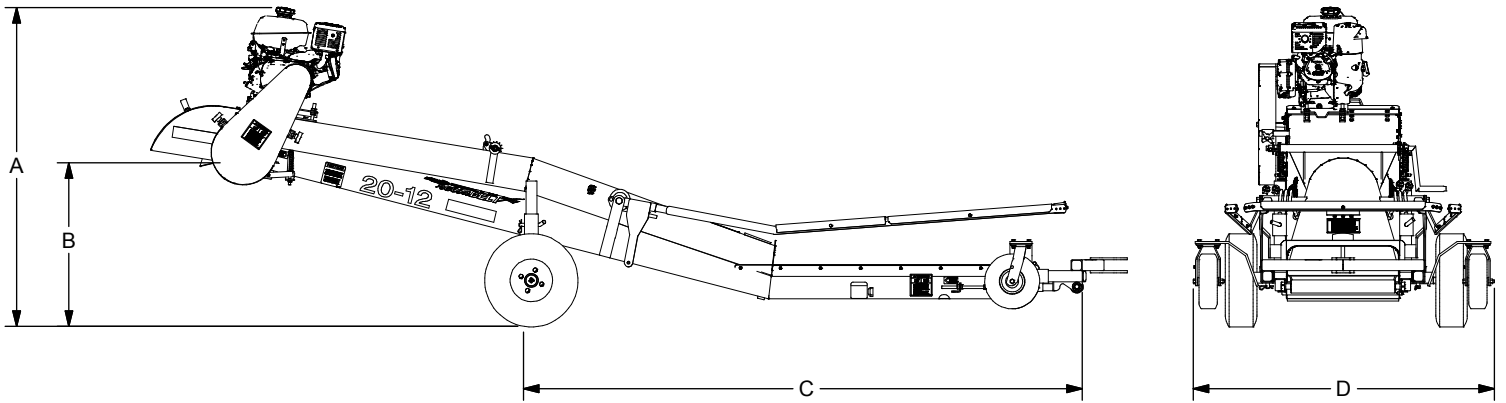

Model	Dimension	Minimum	Maximum
Gas	A	5'2"	6'0"
	B	2'10"	4'0"
	C	8'5"	
	D	4'8"	
Electric	A	4'8"	5'4"
	B	2'10"	4'0"
	C	8'5"	
	D	4'8"	

ELECTRICAL SPECIFICATIONS

There are different voltage and phase options available for the conveyors. The table below lists these various options and the corresponding part numbers. These components must be purchased separately.

Electrical Motor Options And Specifications		
Motor Part Number	Motor Size and Voltage	Full-Load Amps
13000007173	5HP 3PH 575V	5.3
27362	5HP 1PH 230	23.0
18369	5HP 3PH 460V	6.4
18370	5HP 3PH 600V	5.1

BOLT SPECIFICATIONS



The torque value for bolts and capscrews are identified by their head markings. Replacing higher Grade bolts (Grade 8) with lower Grade bolts (Grade 5) will lead to conveyor failure and can result in injury or death. Always use replacement bolts with the same Grade markings as the removed bolt.

BOLT TORQUE VALUES

Torque figures indicated above are valid for nongreased or non-oiled threads and heads unless otherwise specified. Therefore, do not grease or oil bolts or capscrews unless otherwise instructed in this manual. When using locking elements, increase torque values by 5%.

Bolt Diameter A	SAE Grade 2 N.m (ft-lbs)		SAE Grade 5 N.m (ft-lbs)		SAE Grade 8 N.m (ft-lbs)	
1/4	8	(6)	12	(9)	17	(12)
5/16	13	(10)	25	(19)	36	(27)
3/8	27	(20)	45	(33)	63	(45)
7/16	41	(30)	72	(53)	100	(75)
1/2	61	(45)	110	(80)	155	(115)
9/16	95	(70)	155	(115)	220	(165)
5/8	128	(95)	215	(160)	305	(220)
3/4	225	(165)	390	(290)	540	(400)
7/8	230	(170)	570	(420)	880	(650)
1	345	(225)	850	(630)	1320	(970)

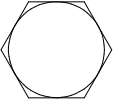
GRADE MARKINGS CHART

 No Marking	Grade 2 Low or Medium Carbon Steel
 3 Radial Lines	Grade 5 Medium Carbon Steel Quenched and Tempered
 6 Radial Lines	Grade 8 Medium Carbon Alloy Steel, Quenched and Tempered

GAS JUMP CONVEYOR PACKAGE CONSISTS OF THE FOLLOWING:

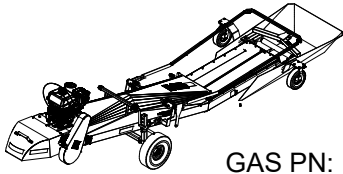

GAS PN: 14200120000

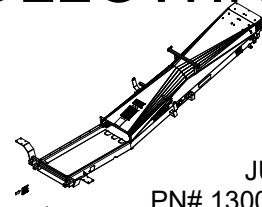

JUMP
PN# 13000006756-00

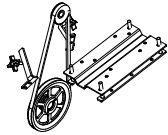

HARDWARE BOX
JUMP GAS
PN# 13000006650-00

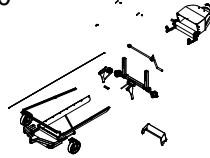

HARDWARE BOX
JUMP
PN# 13000007341-00

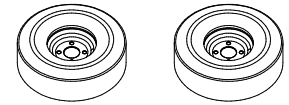

TIRES
PN# 13000007025-00

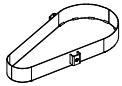

BELT COVER
PN# 13000007272-00

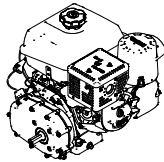

GAS ENGINE
PN# 13000007228-00



BELT DEPRESSOR BUNDLE
PN# 13000007951-00

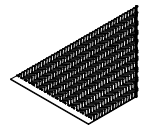

CONVEYOR BELT
PN# 13000007038-00

ELECTRIC JUMP CONVEYOR PACKAGE CONSISTS OF THE FOLLOWING:

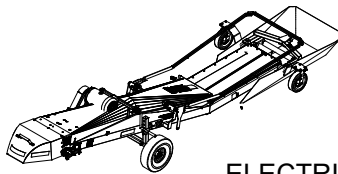

ELECTRIC PN: 14200120100

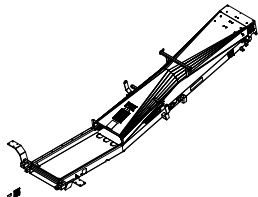

JUMP
PN# 13000006756-00

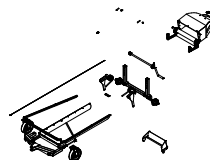

HARDWARE BOX
JUMP
PN# 13000007341-00

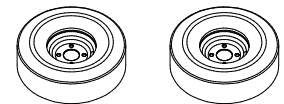

TIRES
PN# 13000007025-00

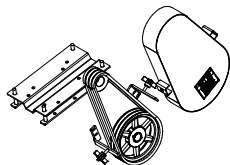

HARDWARE BOX
ELECTRIC JUMP
PN# 13000007344-00

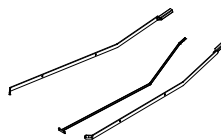

BELT DEPRESSOR BUNDLE
PN# 13000007951-00

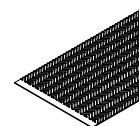

CONVEYOR BELT
PN# 13000007038-00

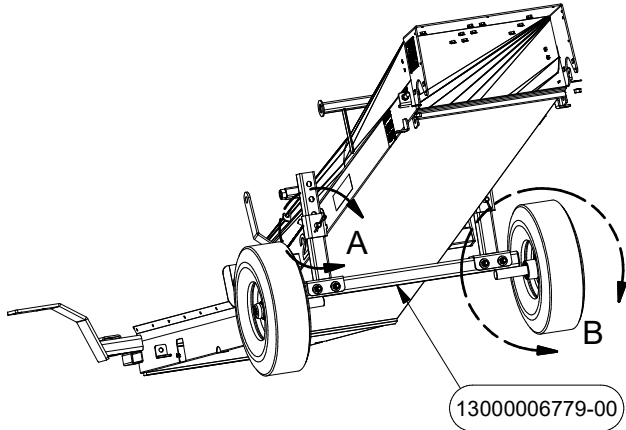
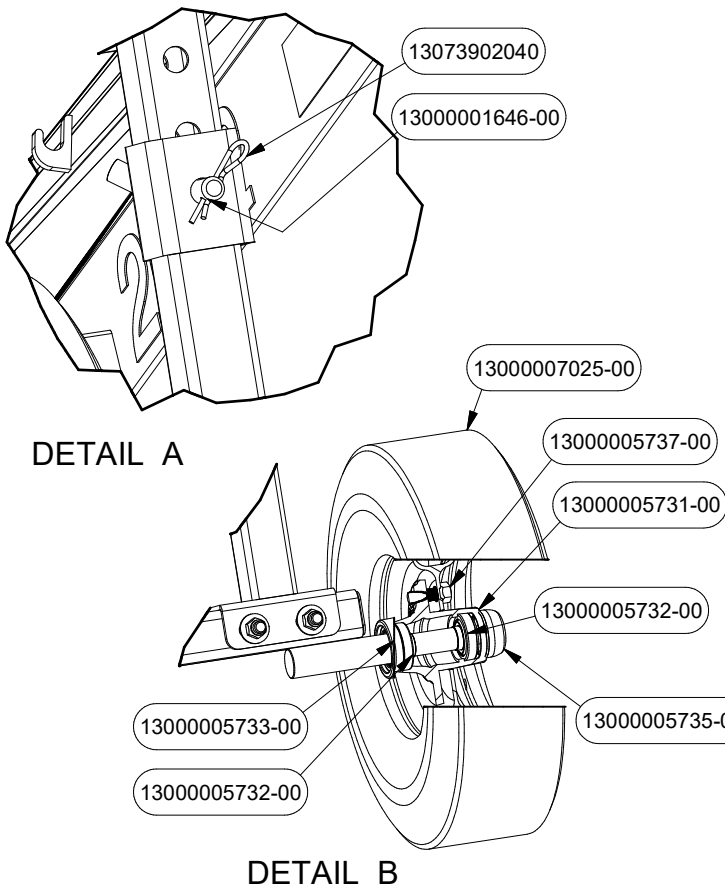

FIGURE 1

1. Install axle PN# 6779 onto jump using bent pull pin PN# 1646 and cotter pin PN# 13073902040, see detail A. Bent pull pin and cotter pin are found in the wheel and hitch bolt bag, PN# 1723. Wheel and hitch bolt bag and axle are found in hardware box PN# 7341.



DETAIL A

DETAIL B

2. Install wheel seals PN# 5733, bearings PN# 5732, wheel hubs PN# 5731, dust caps PN# 5735 and wheels with tires PN# 7025, onto axle. All components except wheels are found in hardware box PN# 7341. See detail B. Repeat on both sides.

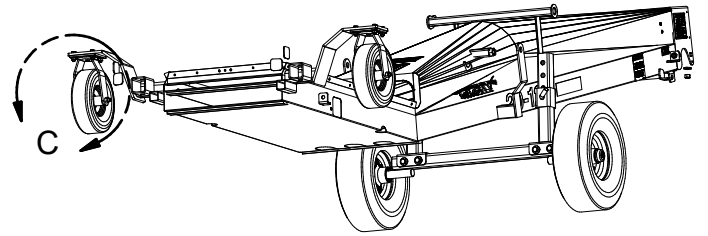
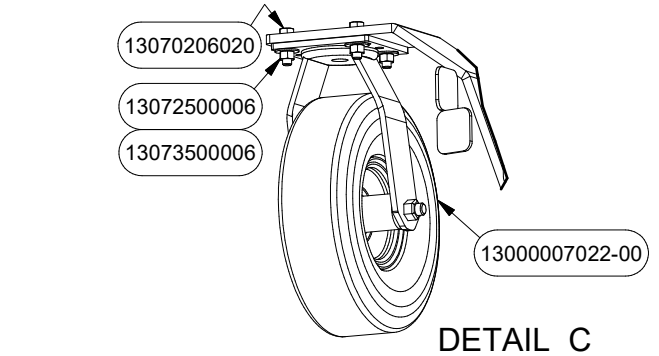

FIGURE 2



DETAIL C

3. Attach the caster wheels PN# 7022 to the jump using bolts and nuts shown. Hardware is found in wheel and hitch bolt bag PN# 1723. Wheel and hitch bolt bag and casters are found in hardware box PN# 7341. Repeat on both sides.

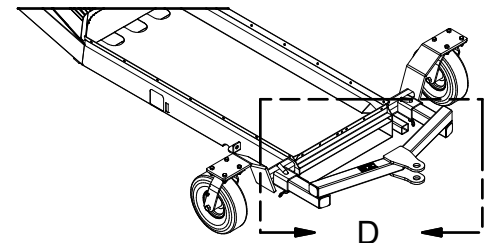
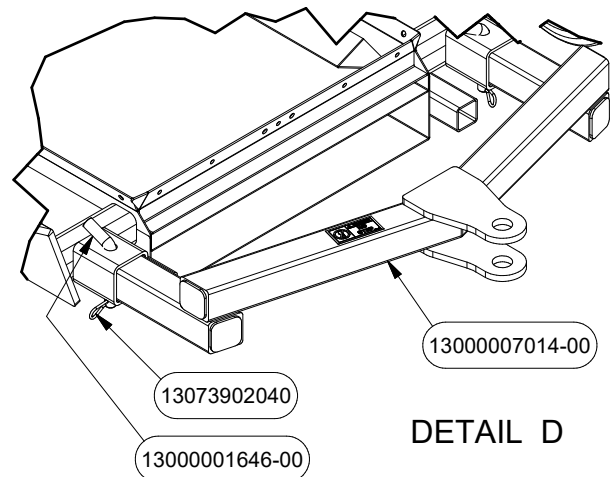

FIGURE 3



DETAIL D

3. Slide the hitch, PN# 7014 into the jump as shown in Figure 3 and Detail D on previous page. Insert bent pull pin PN#1646 and cotter pin PN# 13073902040 on both sides. Bent pull pin and cotter pin are found in the wheel and hitch bolt bag, PN# 1723. Hitch and wheel and hitch bolt bag are found in hardware box PN# 7341.

4. Slide LH bottom roller adjuster PN# 6679 and RH bottom roller adjuster PN# 6706 into jump. Insert bottom roller PN#6125 into adjusters and secure on each side using collars PN# 6121. See Figure 4. LH & RH bottom roller adjusters, bottom roller and collars are found in hardware box PN# 7341

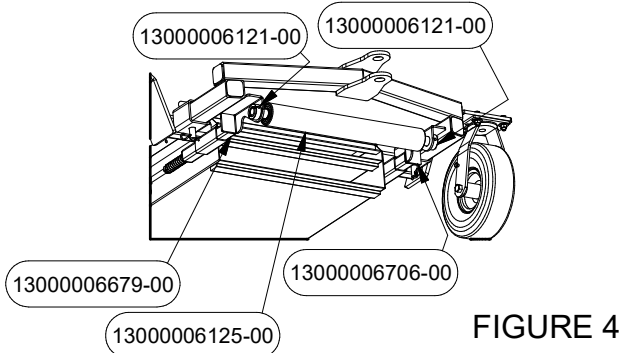

FIGURE 4

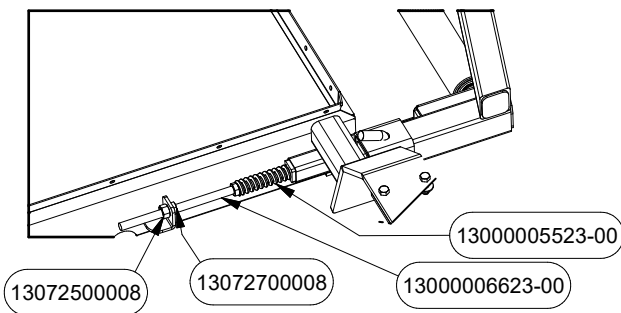

FIGURE 5

5. Insert threaded adjuster PN# 6623 into LH adjuster through spring PN# 5523. Secure threaded adjuster with jam nut PN# 13072700008 and nut PN# 13072500008. Repeat for right side. Nuts and jam nuts are found in intake roller bolt bag PN# 7338. Intake roller bolt bag, threaded adjuster and springs are found in hardware box PN# 7341.

6. Install return scraper PN# 5553 in jump and secure on right side with bolt PN# 13070204016 and washer PN# 13073600004, see Figure 6. Bolt and nut are found in intake roller bolt bag PN# 7338. Intake roller bolt bag and return scraper are found in hardware box PN# 7341.

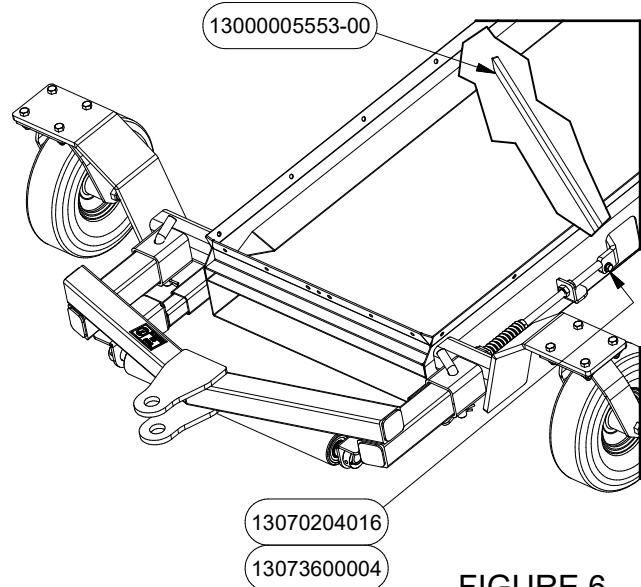

FIGURE 6

7. At the discharge end of the jump install drive roller PN# 7036 and bearings PN# 6727. Fasten with carriage bolts PN# 13070908024 and nuts PN# 13073100008130. On both sides install adjuster tab PN# 5503 with nut PN#13072500008 and jam nut PN# 13072700008. Hardware is found in discharge roller bolt bag PN# 7340. Discharge roller bolt bag, drive roller, bearings and adjuster tabs are found in hardware box PN# 7341.

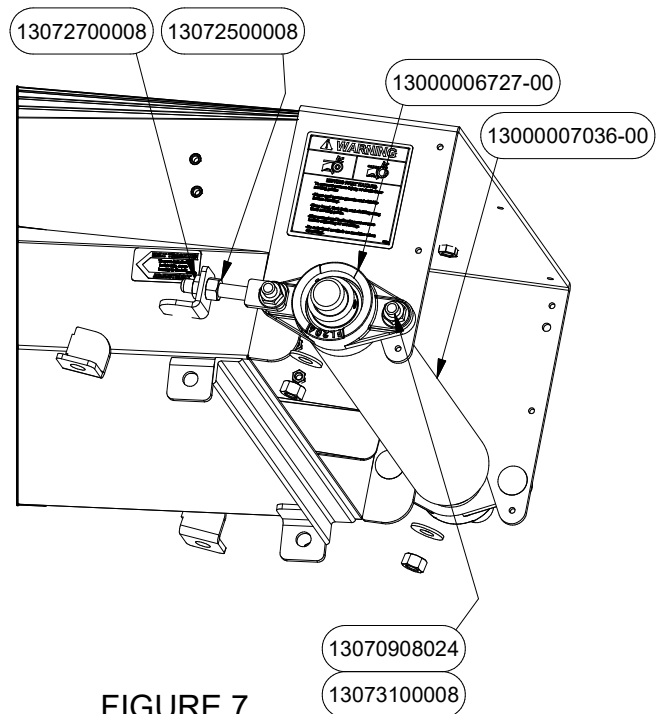

FIGURE 7

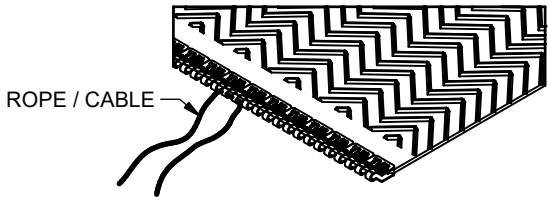

FIGURE 8

8. Attach a cable or rope to one end of the conveyor Belt PN# 7038, see Figure 8. Insert the belt in the intake with the smooth side down. Pull it into the tube structure with the cable or rope until it comes out from the discharge. Thread the cable or rope over, around and under the discharge roller and back through the bottom of the tube structure. Pull the belt back through the tube structure to the intake. Pull the belt around the intake roller and join belt ends to each other using the belt connectors. Ensure the retaining washer is crimped onto the lacing pin and the 4 edge alligator clips are crimped to retain lacing pin. To crimp the alligator clip set the gap in a pair of vice grip jaws to 1/4" and squeeze the clip until the vice grips lock. See Figure 9.

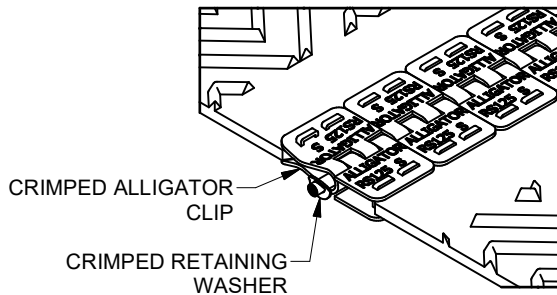

FIGURE 9

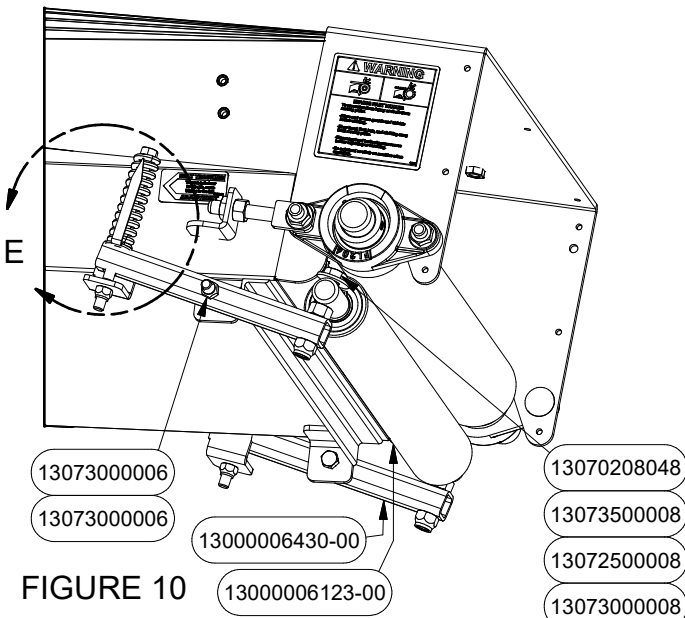
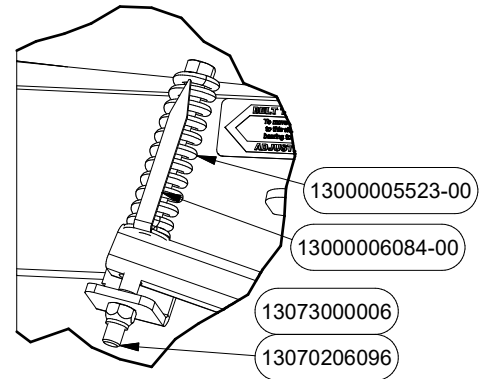

FIGURE 10



DETAIL E

8. At the discharge end of the jump install pinch tubes PN# 6430 onto jump using bolts PN# 13070206036 and nuts PN# 13073000006. Install pinch roller PN# 6123 onto pinch tubes using bolts PN# 13070206040 and nuts PN# 13073000006. See Figure 10. Fasten pinch springs PN# 5523 and roller tension indicator PN# 6084 to the other end of the pinch tubes with bolts PN# 13070206096 and nuts PN# 13073000006. See Detail E. All Hardware for step 9 is found in discharge roller bolt bag PN# 7340. Discharge roller bolt bag, pinch tubes, pinch roller, pinch spring and roller tension indicator is found in hardware box PN# 7341.

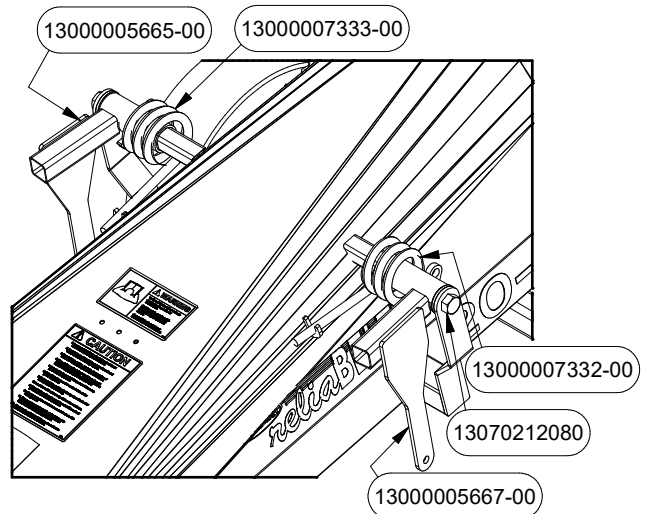

FIGURE 11

Note: All hardware used in steps 9-13 is found in canvas and depressor bolt bag PN# 7337. All other parts are found in hardware box PN# 7341.

9. Install LH and RH pivots PN# 5665 and 5667, LH and RH hopper springs PN# 7333 and 7332 and bolts PN# 1307021080 onto jump as shown in Figure 11.

SETUP

10. Set LH and RH hopper hoops PN# 7059 and 7058 into LH and RH pivots. Next feed the hopper canvas PN# 7618 (not shown) on to hopper hoops. Feed front hopper hoop into the canvas and fasten to LH and RH hopper hoops and canvas corner plates PN# 6923 with bolts PN# 13070204020 and nuts PN# 13073000004. See Figure 12. Note canvas not shown for clarity. The canvas should be pinched and supported between canvas corner plate and hopper hoops.

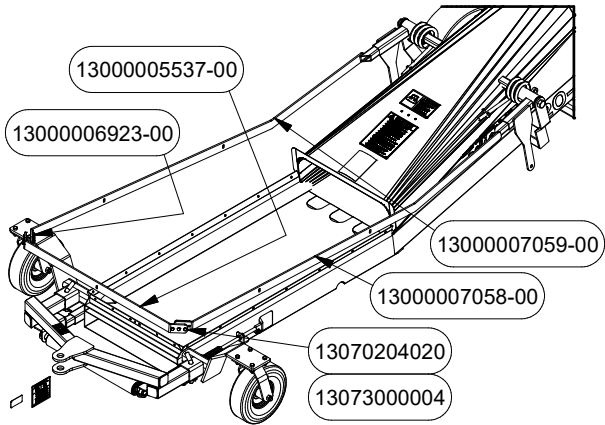

FIGURE 12

12. Fasten belt depressor PN# 7017 to the end of the hopper on the jump using bolts PN# 13070204016 and nuts PN# 13073000004. See Figure 14. Slide the opposite end of the belt depressor in to the belt depressor guide PN# 6739 and fasten guide to the inside of jump with bolts PN# 130702050012 and nuts PN# 130730000005. See Detail F.

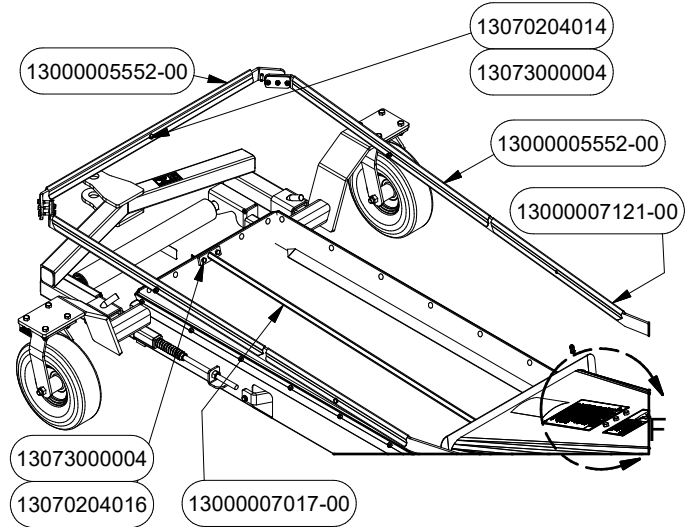

FIGURE 14

11. Slide 45" canvas supports PN# 7106 into canvas bottom pocket and 20" canvas support PN# 5556 into canvas bottom front pocket. Fasten canvas bottom with canvas support plates and front and side rubber hopper flashing PN# 6569 and PN# 6756 to the jump using carriage bolts and nuts PN# 13070904012 and PN# 13073000004. See Figure 13. Canvas bottom and canvas supports should be sandwiched between rubber hopper flashing and jump.

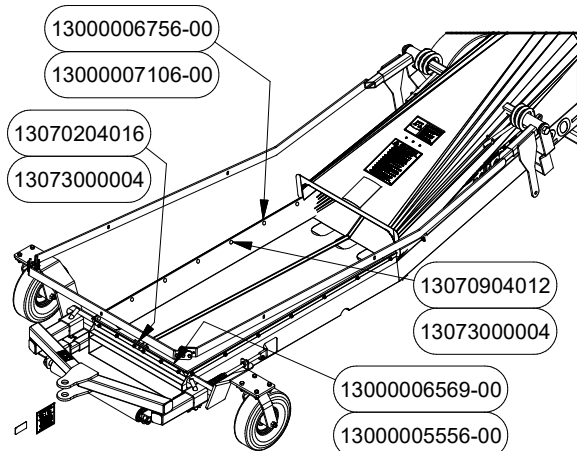
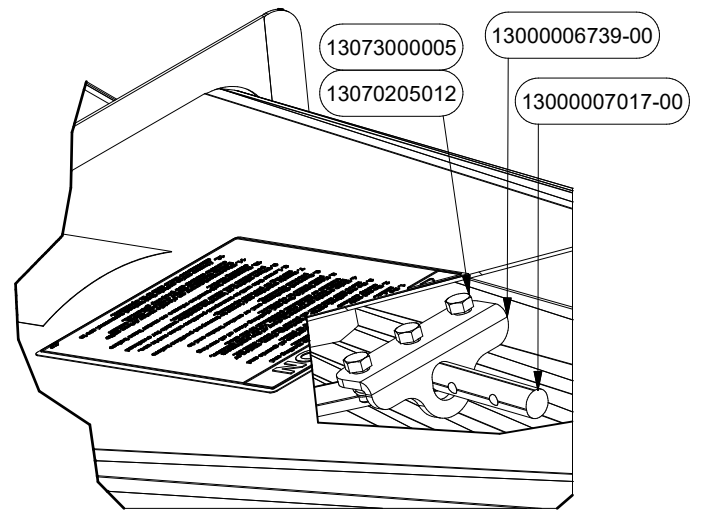

FIGURE 13



DETAIL F

13. Place one 30" hopper clip PN# 5552 on each of the front, LH and RH hopper hoops as well as one 20" hopper clip PN# 7121 on each of the LH and RH hopper hoops. Fasten each hopper clip with one bolt PN# 13070204014 and nut PN# 13073000004. See Figure 14.

SETUP

14. Slide LH crank sleeve PN# 6226 onto crank PN# 5507 as shown in Detail F (on following page). Slide crank into jump from the LH side as shown in Figure 15. Install RH crank sleeve PN# 6227 on the other side. Fasten LH and RH crank sleeves onto crank using bolts PN# 13070204024 and nuts PN# 13072900004. Insert bolts through the outermost holes in the sleeves. Hardware is found in crank bolt bag PN# 6027. Crank bolt bag and all other parts are found in hardware box PN# 7341.

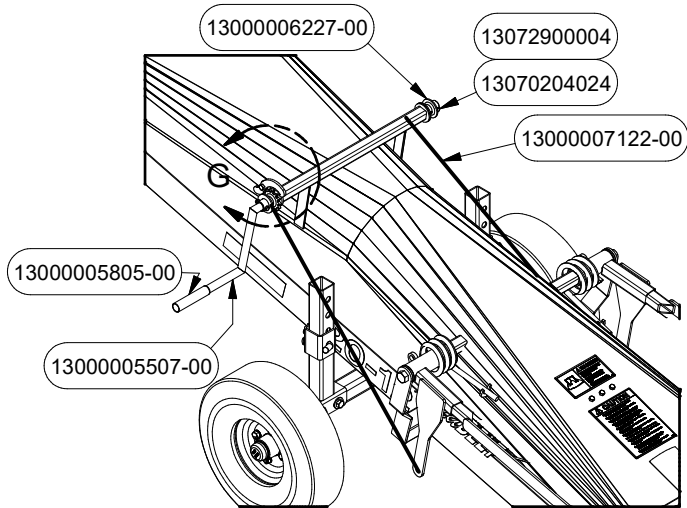
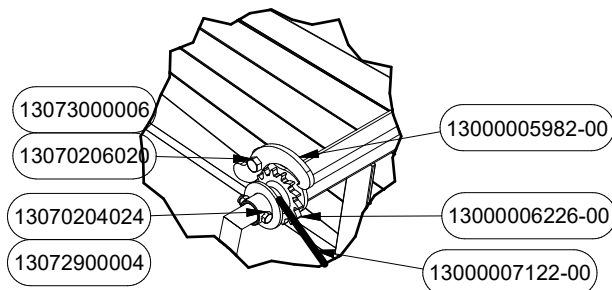

FIGURE 15



DETAIL G

15. Install crank stop PN# 5982 onto jump as and fasten with bolt PN# 13070206020 and nut PN# 130730000006. Install grip PN# 5805 onto crank. Loop cable PN# 7122 through LH pivot lower hole, as shown in Figure 15 and clamp to itself using cable clamp PN# 1060. Thread other end of cable through LH crank sleeve, through crank and back out RH crank sleeve. Loop free cable end around RH pivot and secure with cable clamp. Cable clamps are found in canvas and depressor bolt bag PN# 7337 all other hardware is found in crank bolt bag PN# 6027. Bolt bags and all other parts are found in hardware box PN# 7341.

16. Locate discharge spout PN# 7054 and deflector PN# 7056 on the discharge end of the jump as shown in Figure 16. Secure Secure with self tapping screws PN# 130704012. Fasten handle PN# 7016 to discharge spout with bolts PN# 13070204012 and nuts PN# 13072500004. Hardware is found in discharge bolt bag PN# 7339. discharge bolt bag and all parts are found in hardware box PN# 7341.

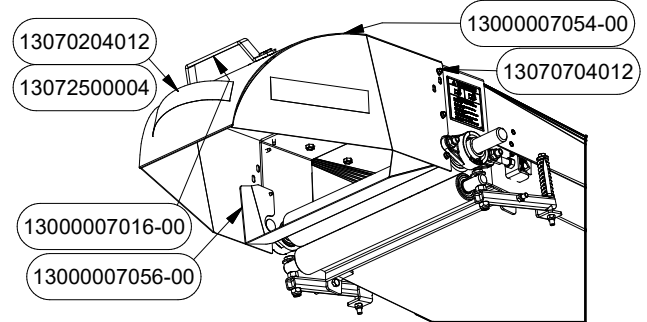

FIGURE 16

17. Install motor mount adjusters PN# 7063 onto jump, fasten with bolts PN# 13070206014. Use washers PN# 130735000006 as spacers underneath motor mount adjusters where necessary. Note that locations for motor mount adjusters vary depending on whether a gas engine or electric motor is used. Gas engine setup shown, electric motor is opposite. Install bolts PN# 13070206014 in unused holes. See Figure 17. Bolts are found in motor mount bolt bag PN# 7342. motor mount bolt bag and all parts are found in hardware box PN# 7346.

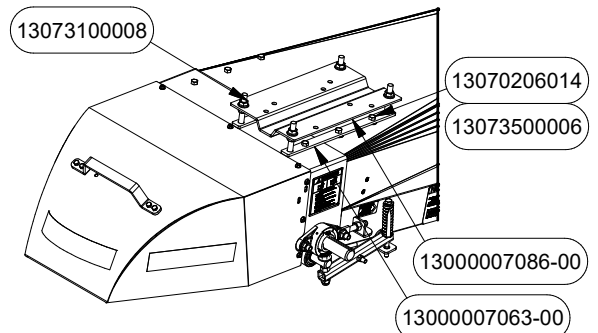

FIGURE 17

17. Thread one nut PN# 13073100008 onto each of the motor mount adjuster studs with the flange side up. Slide motor mount onto the motor mount adjuster studs and thread one more nut PN# 13073100008 onto each stud, flange side down. See Figure 17. Nuts are found in gas motor bolt bag PN# 7345, motor mount bolt bag and motor mount are found in hardware box PN# 7346.

SETUP

18. Install gas engine PN# 7228 onto motor mount and fasten with bolts PN# 13070206028, washers PN# 13073500006 and nuts PN# 13073000006. Hardware is found in gas motor bolt bag PN# 7345, gas engine is shipped on its own. See Figure 18.

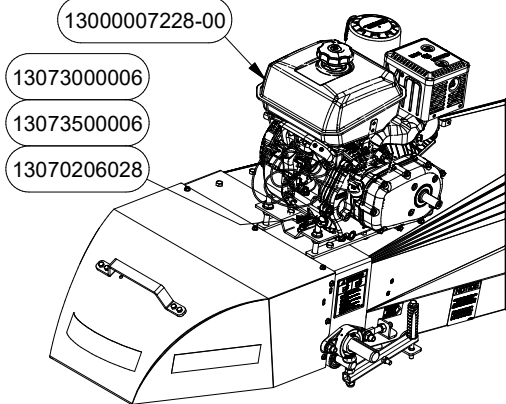

FIGURE 18

19. Mount belt sheave PN# 7035 onto bushing PN# 7193. Slide onto drive roller with key PN# 6791 but do not tighten bushing bolts. Mount belt sheave PN# 7034 onto bushing PN# 7280. Slide onto engine shaft with key PN# 6791. Align belt sheaves with each other and tighten bushing bolts in place. Install belts PN# 7230 on belt sheaves. Adjust height of motor mount and engine using nuts motor mount adjuster studs to install belt and then again to achieve proper tension on the belt. See Figure 19.

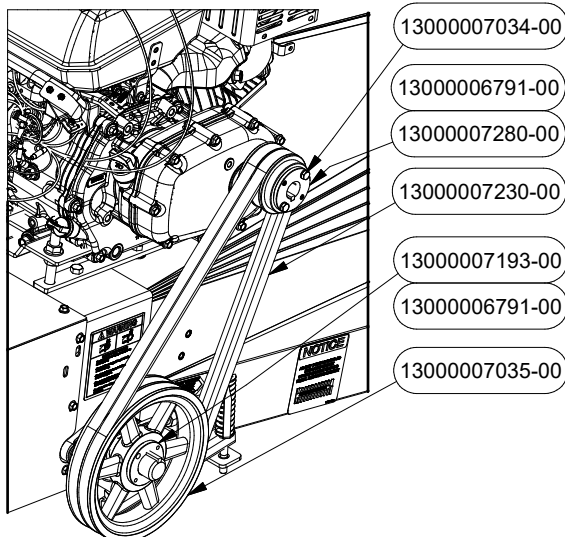

FIGURE 19

20. Install belt shield brace PN# 5567 onto jump and fasten with bolts PN# 13070204012, washers PN# 13073600004 and nuts PN# 13072500004. See Figure 20.

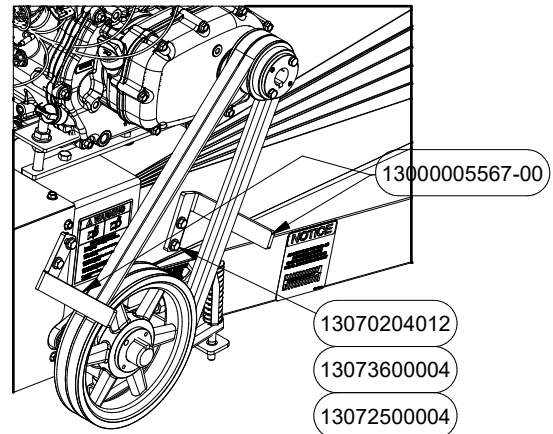

FIGURE 20

21. Slide belt cover PN# 7272 onto belt shield braces and secure with handwheels PN# 5802. See Figure 21

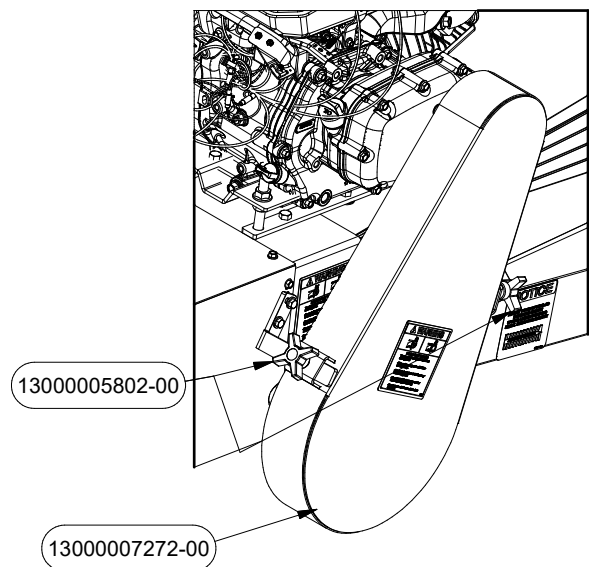
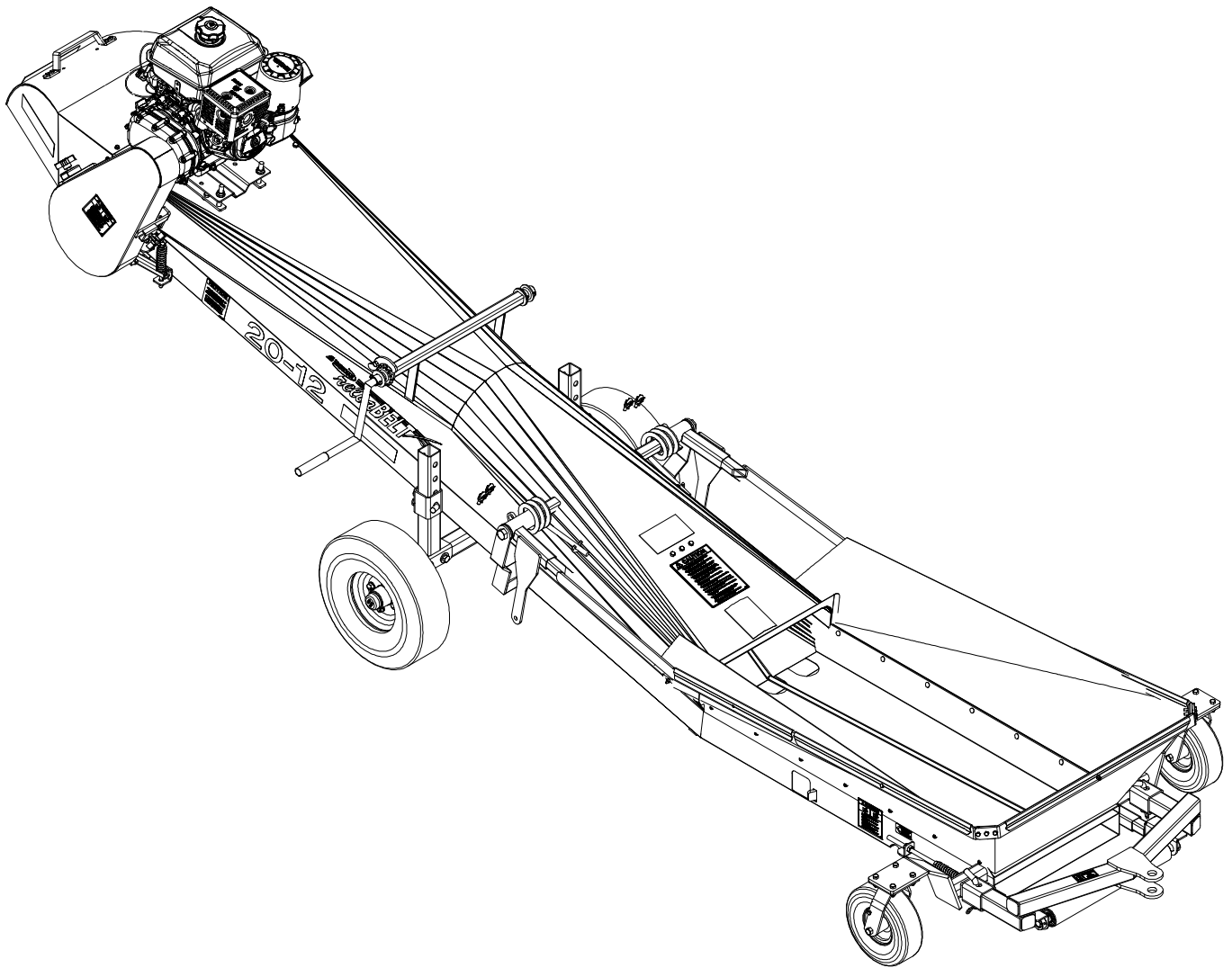

FIGURE 21

JUMP CONVEYOR FINISHED ASSEMBLY



FINAL CHECK AND TESTING

INITIAL CONVEYOR ASSEMBLY

Meridian Reliabelt Conveyors come fully assembled. A minimum amount of tools are required to check the conveyor before the first use, but no assembly is required. Complete the Final Check and Testing in the next section to ensure all fasteners are tight and the conveyor assembly is ready to use.

CHECKLIST

All line items must be able to have the “Yes” column checked. If the line refers to an option that is not on the conveyor being tested, then “n/a” is to be placed on that line.

Item to Check	Yes	No
Scraper is in place.		
All covers/shields are in place.		
Conveyor belt tracks in the center of the roller.		
Conveyor belt tension is correct.		
Drive belt tension is correct.		
Hopper canvas is in place.		
Electric drive motor functions properly.		
Conveyor belt operates in the proper direction (electric motor option).		
Touch up paint is applied where needed.		
All hazard labels are attached.		
Tires are properly inflated.		

PARTS LIST

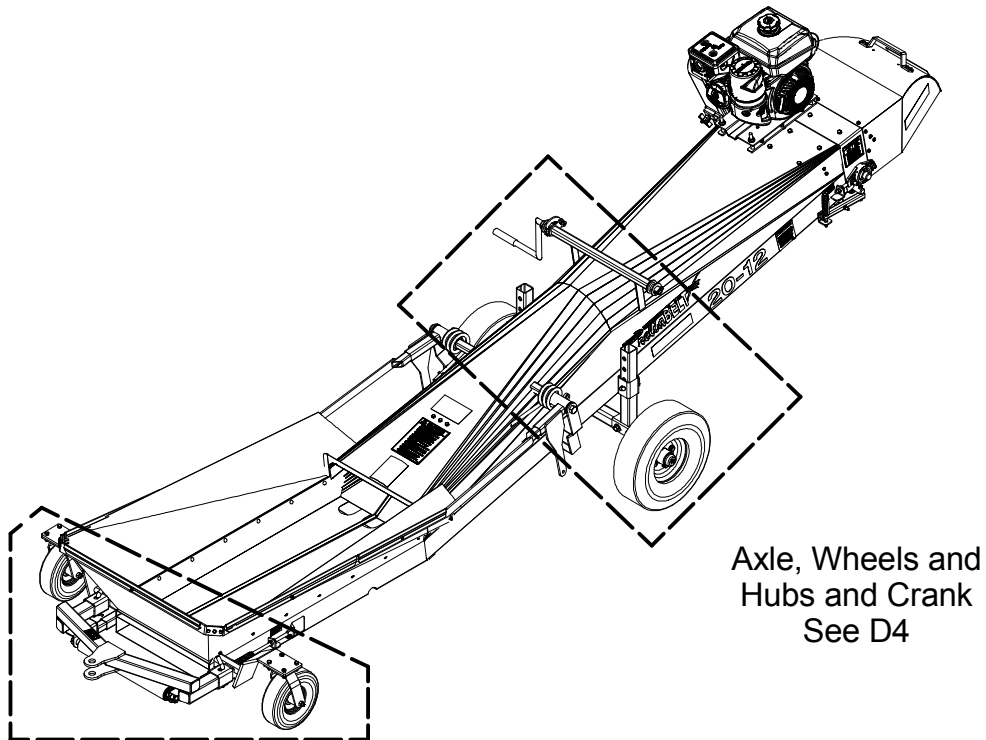
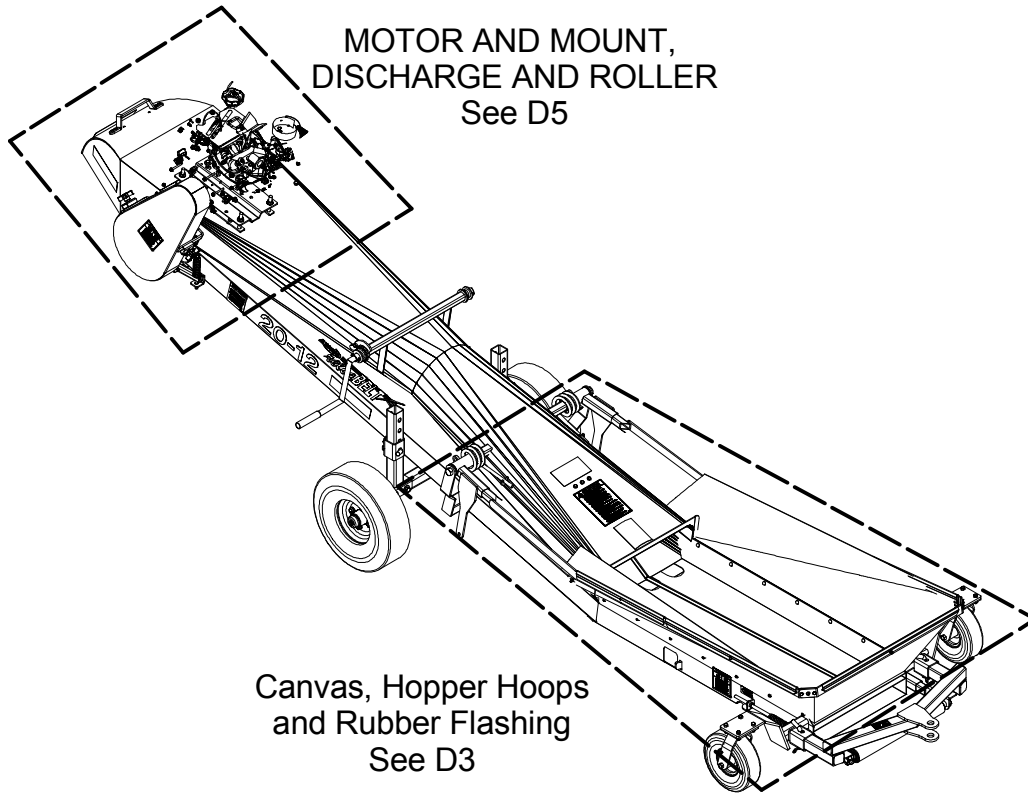

HITCH, INTAKE ROLLER, CASTERS AND SCRAPER

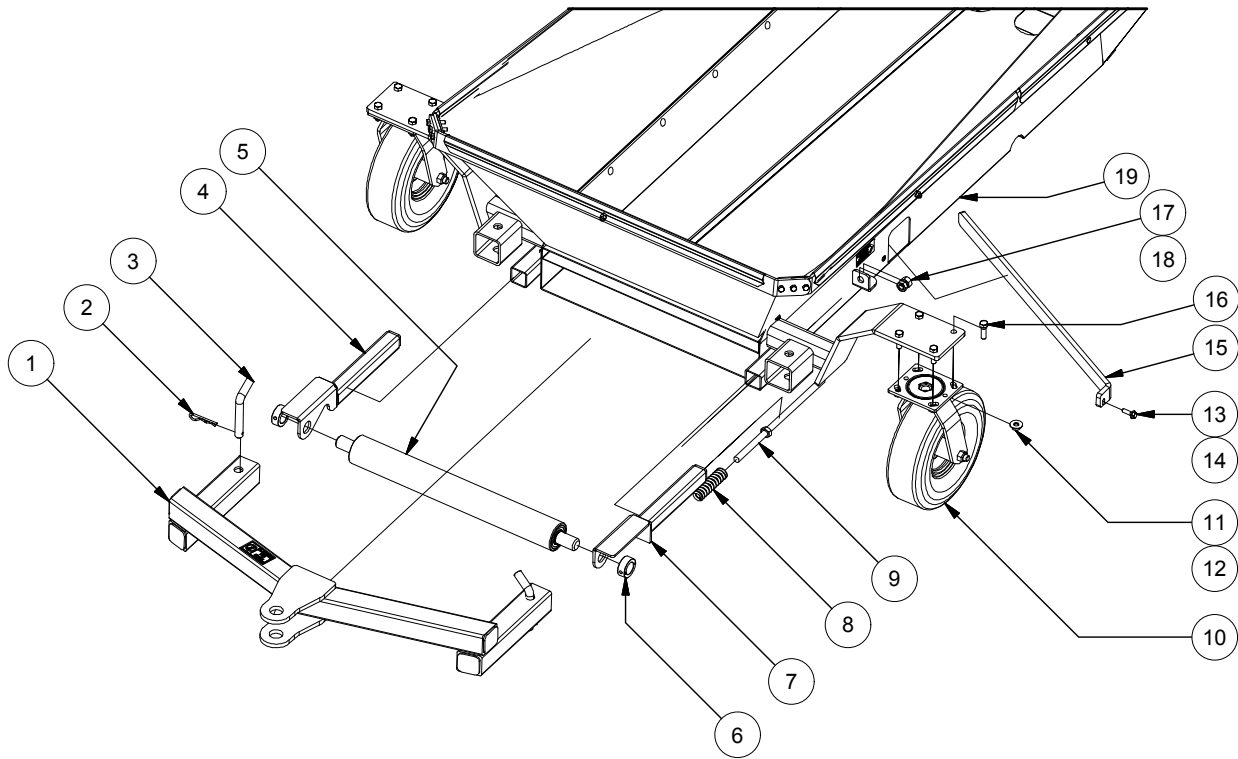

MERIDIAN RELABELT JUMP CONVEYOR			
REF #	PART #	QUANTITY	DESCRIPTION
1	13000007014-00	1	Hitch - Grey
2	13073902040	2	1/8" x 2 1/2" Hair Pin
3	13000001646-00	2	Bent Pull Pin 5/8" x 3"
4	13000006679-00	1	Adjuster - Bottom Roller LH - Grey
5	13000006125-00	1	Roller - Bottom 20-15
6	13000006121-00	2	Collar - 1" Set Screw
7	13000006706-00	1	Adjuster - Bottom Roller RH - Grey
8	13000005523-00	2	Spring - Pinch
9	13000006623-00	2	Adjuster - Bottom Roller
10	13000007022-00	2	Caster - 10" Swivel 410/350-4
11	13072500006	8	NUT, HEX 3/8-16 UNC Steel, Mild
12	13073500006	8	Flat Washer - 3/8 Yellow Zinc Plated
13	13070204016	1	BOLT, HEX, 1/4-20 UNC X 1 Steel, Mild
14	13073600004	1	WASHER, FLAT 1/4
15	13000005553-00	1	Scraper - Return - Intake
16	13070206020	8	BOLT, HEX, 3/8-16 UNC X 1.25 Steel, Mild
17	13072500008	2	NUT, HEX 1/2-13 UNC ZINC PLATED
18	13072700008	2	NUT, HEX, JAMB 1/2-13 UNC Steel, Mild
19	13000006756-00	1	JU20-12 - Red

CANVAS, HOPPER HOOPS AND RUBBER FLASHING

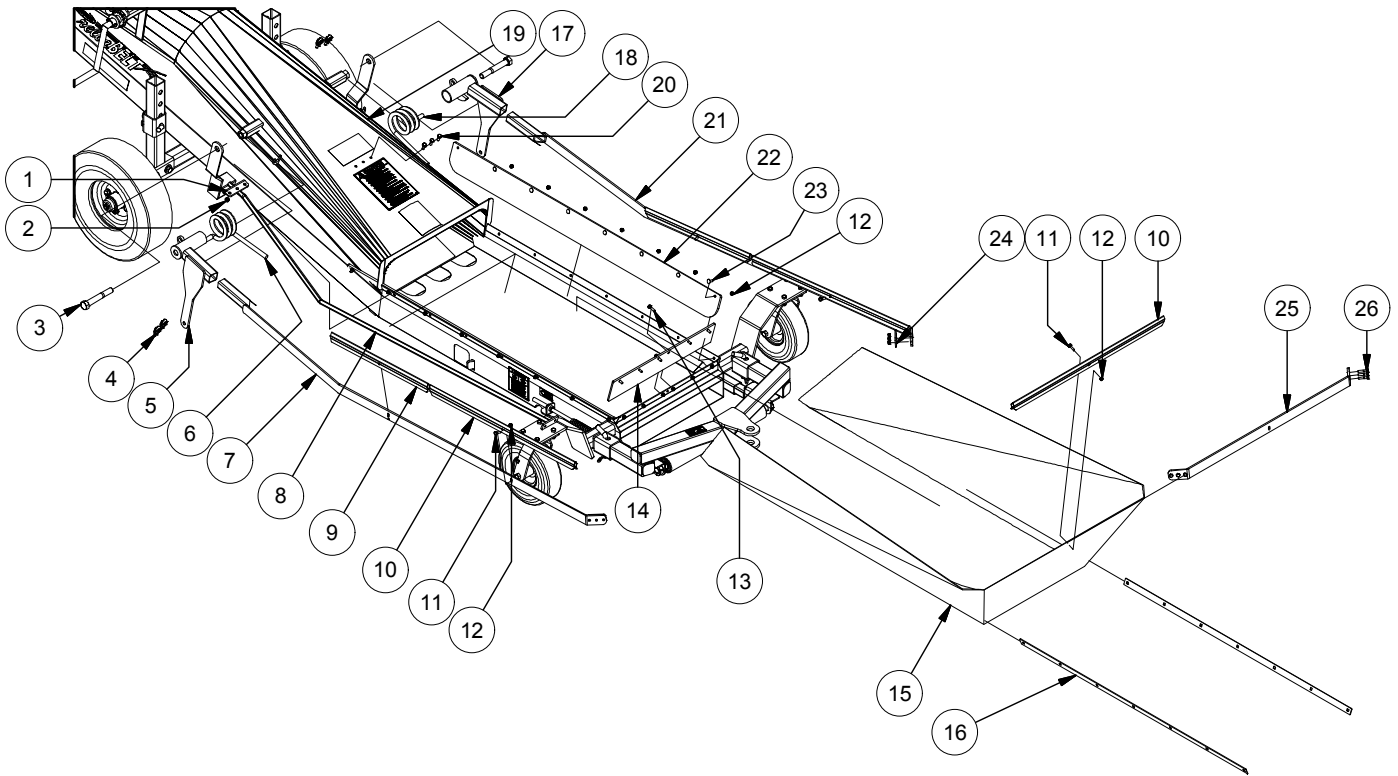

MERIDIAN RELIABELT JUMP CONVEYOR

REF #	PART #	QUANTITY	DESCRIPTION
1	13000006739-00	1	Belt Depressor Guide
2	13073000005	3	Stover Locknut 5/16-18 Type C
3	13070212080	2	BOLT, HEX, 3/4-10 UNC X 5 Steel, Mild
4	13000001060-00	4	1/4" Galv. Cable Clamp
5	13000005665-00	1	Pivot LH - Intake L/P 5' - Grey
6	13000007333-00	1	Spring - Hopper Left - JU20-12
7	13000007059-00	1	Hoop - Hopper RH - Grey
8	13000007017-00	1	Belt Depressor - Grey
9	13000007121-00	2	Hopper Clip-20 in
10	13000005552-00	3	Hopper Clip-30 in
11	13070204014	5	BOLT, HEX, 1/4-20 UNC X 0.875 Steel, Mild
12	13073000004	33	NUT, HEX, NYLOCK1/4-20 UNC Steel, Mild
13	13070204016	3	BOLT, HEX, 1/4-20 UNC X 1 Steel, Mild
14	13000006569-00	1	Rubber-Hopper Flashing End-Intake 5'
15	13000007618-00	1	CANVAS - HOPPER - JU20-12
16	13000007106-00	2	Support - Canvas - 45"
17	13000005667-00	1	Pivot RH - Intake L/P 5' - Grey
18	13000007332-00	1	Spring - Hopper Right - JU20-12
19	13000006756-00	1	JU20-12 - Red
20	13070205012	3	BOLT, HEX, 5/16-18 UNC X 0.75 Steel, Mild
21	13000007058-00	1	Hoop - Hopper LH - Grey
22	13000007088-00	2	Rubber - Hopper Flashing
23	13070904012	20	BOLT, CARRIAGE 1/4-20 UNC x 0.75 Steel, Mild
24	13000006923-00	2	Plate - Canvas Corner
25	13000005537-00	1	Arm - Cross - Canvas
26	13070204020	6	BOLT, HEX, 1/4-20 UNC X 1.25 Steel, Mild

AXLE, WHEELS AND HUBS AND CRANK

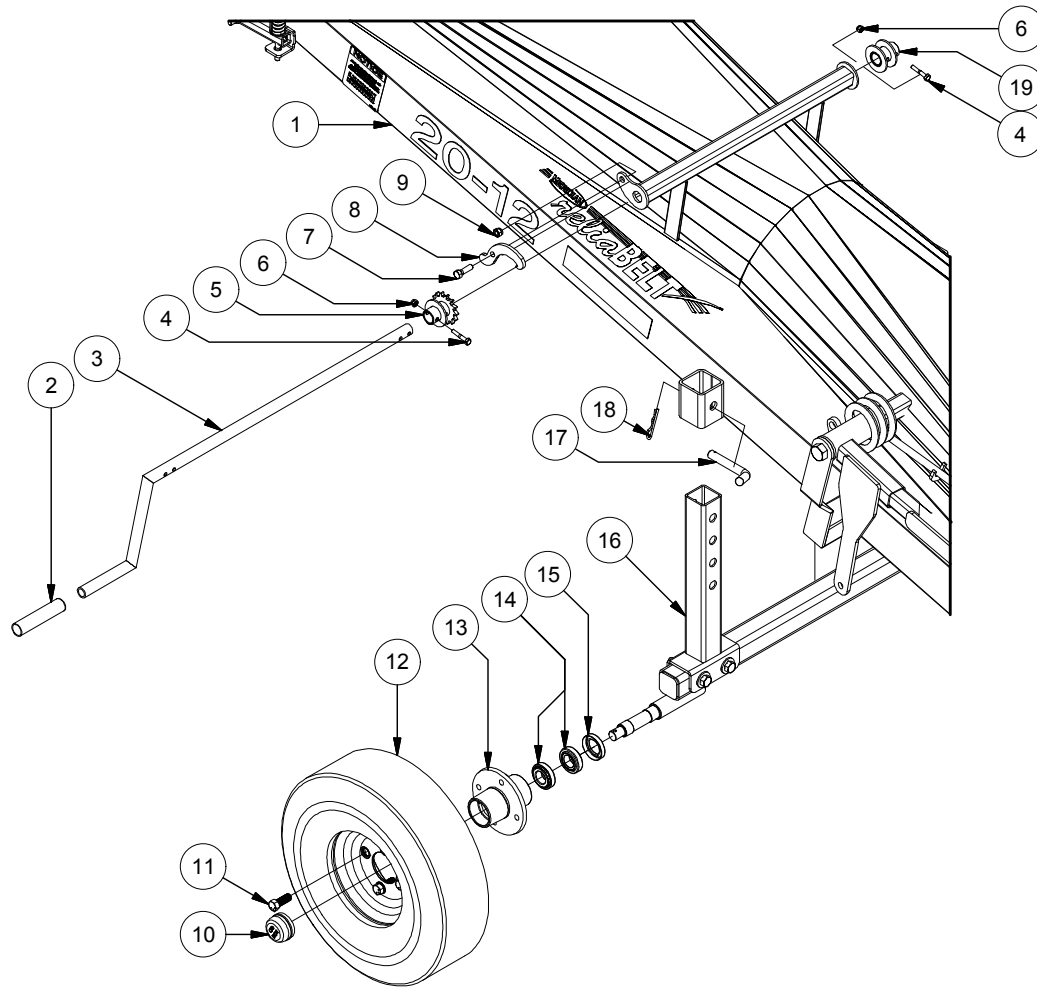

MERIDIAN RELABELT JUMP CONVEYOR			
REF #	PART #	QUANTITY	DESCRIPTION
1	13000006756-00	1	JU20-12 - Red
2	13000005805-00	1	Grip - Rubber Handle
3	13000005507-00	1	Crank - Cross - Intake - Grey
4	13070204024	2	BOLT, HEX, 1/4-20 UNC X 1.5 Steel, Mild
5	13000006226-00	1	Crank - LH Sleeve - Grey
6	13072900004	2	NUT, HEX, NYLOCK1/4-20 UNC Steel, Mild
7	13070206020	1	BOLT, HEX, 3/8-16 UNC X 1.25 Steel, Mild
8	13000005982-00	1	Stop - Crank - Intake
9	13073000006	1	NUT, HEX, NYLOCK3/8-16 UNC Steel, Mild
10	13000005735-00	2	Dust Cap - DC11
11	13000005737-00	8	Wheel Bolt - .50-2UNF-2A X 1.75
12	13000007025-00	2	Wheel - 10" Tire + Rim
13	13000005731-00	2	Hub - 4 Bolt hd211
14	13000005732-00	4	Bearing Cone - Outer L44643
15	13000005733-00	2	Grease Seal - SE10
16	13000006779-00	1	Axle - Jump 20-12 - Black
17	13000001646-00	2	Bent Pull Pin 5/8" x 3"
18	13073902040	2	1/8" x 2 1/2" Hair Pin
19	13000006227-00	1	Crank - RH Sleeve - Grey

MOTOR AND MOUNT, DISCHARGE AND ROLLER

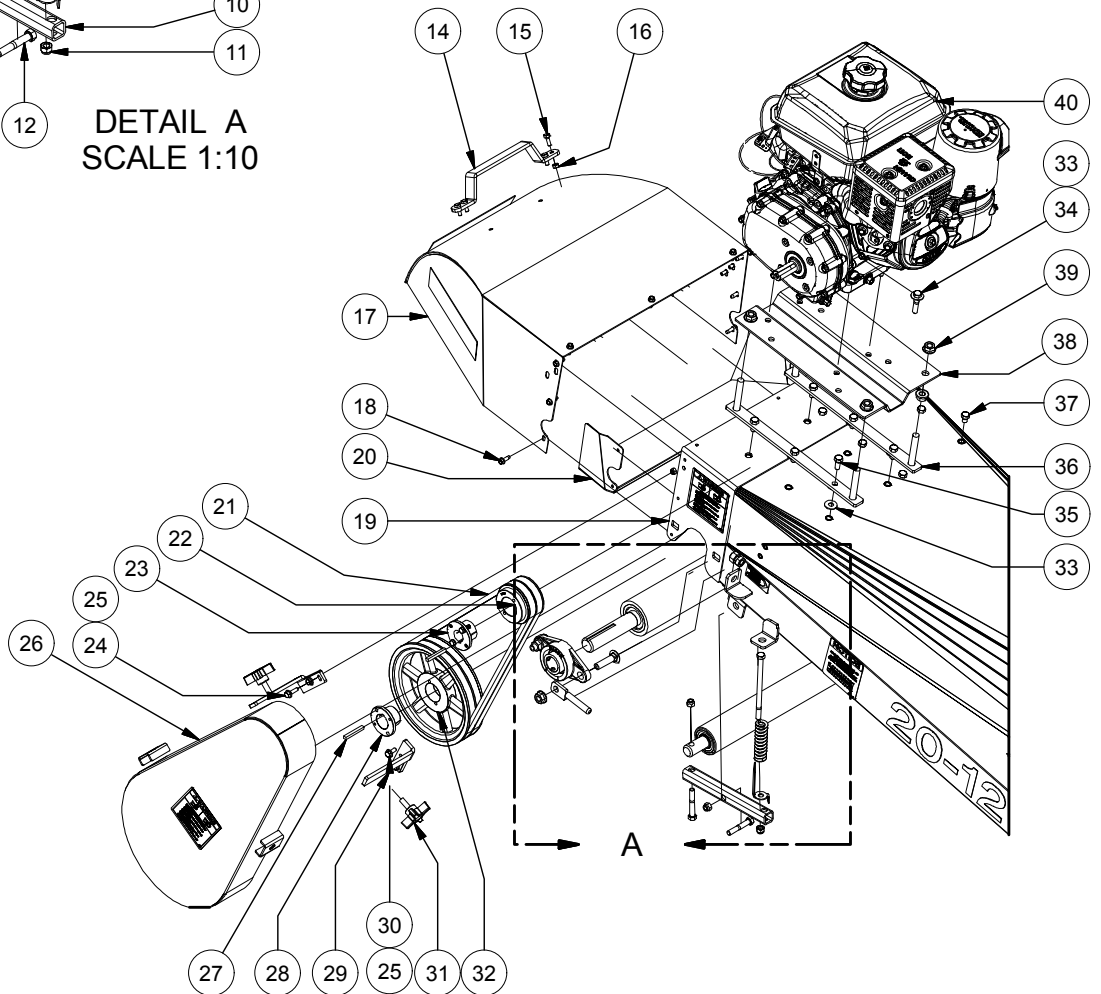
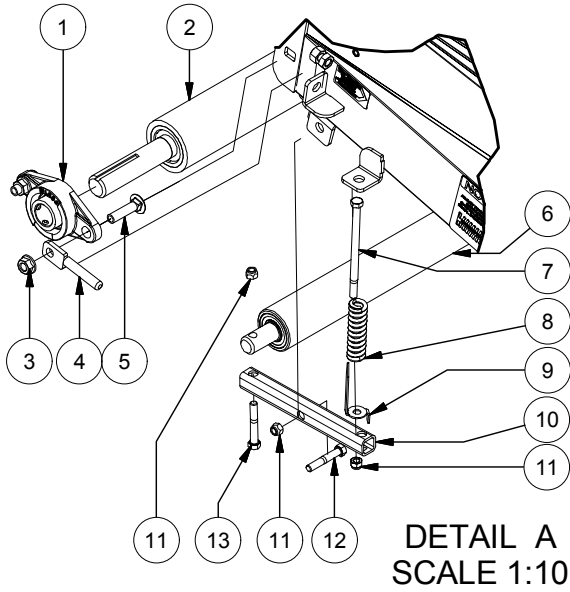

PARTS LIST

MOTOR AND MOUNT, DISCHARGE AND ROLLER

MERIDIAN RELIABELT JUMP CONVEYOR			
REF #	PART #	QUANTITY	DESCRIPTION
1	13000006727-00	2	Bearing - 1 1/4" Timken c/w Housing
2	13000007036-00	1	Roller - Drive Jump
3	13073100008	2	NUT, HEX, FLANGED, Steel, Mild 1/2-13 UNC
4	13000005503-00	2	Adjuster Tab
5	13070908032	2	BOLT, CARRIAGE 1/2-13 UNC x 2 Steel, Mild
6	13000006123-00	1	Roller- Pinch 20-15
7	13070206096	2	BOLT, HEX, 3/8-16 UNC X 6 Steel, Mild
8	13000005523-00	2	Spring - Pinch
9	13000006084-00	2	Indicator - Roller Tension
10	13000006430-00	2	Pinch Tube - Top Drive - Grey
11	13073000006	6	NUT, HEX, NYLOCK3/8-16 UNC Steel, Mild
12	13070206036	2	BOLT, HEX, 3/8-16 UNC X 2.25 Steel, Mild
13	13070206040	2	BOLT, HEX, 3/8-16 UNC X 2.5 Steel, Mild
14	13000007016-00	1	Handle - Discharge
15	13070204012	4	BOLT, HEX, 1/4-20 UNC X 0.75 Steel, Mild
16	13072500004	4	NUT, HEX 1/4-20 UNC Steel, Mild
17	13000007054-00	1	Discharge - Open Spout - JU20-12 - Red
18	13070704012	9	SCREW, FLANGED, SELF-TAPPING 1/4-20 UNC X 0.75 Steel, Mild
19	13000006756-00	1	JU20-12 - Red
20	13000007056-00	1	Deflector - Red
21	13000007230-00	2	V-Belt - B49
22	13000007034-00	1	Belt Sheave - 2BK32H
23	13000007280-00	1	Bushing - H 1"
24	13070204016	2	BOLT, HEX, 1/4-20 UNC X 1 Steel, Mild
25	13073600004	4	WASHER, FLAT 1/4
26	13000007272-00	1	Cover - Belt - Grey
27	13000006791-00	2	Key - 1/4 x 1/4 x 2
28	13000007193-00	1	Bushing - H 1 1/4"
29	13000005567-00	2	Belt Shield Brace 90
30	13070204012	2	BOLT, HEX, 1/4-20 UNC X 0.75 Steel, Mild
31	13000005802-00	2	Handwheel - Plastic 3/8
32	13000007035-00	1	Belt Sheave - 2BK90H
33	13073500006	12	Flat Washer - 3/8 Yellow Zinc Plated
34	13070206028	4	BOLT, HEX, 3/8-16 UNC X 1.75 Steel, Mild
35	13070206014	6	BOLT, HEX, 3/8-16 UNC X 0.875 Steel, Mild
36	13000007063-00	2	Adjuster - Motor Mount Electric - Grey
37	13070206008	6	BOLT, HEX, 3/8-16 UNC X 0.5 Steel, Mild
38	13000007086-00	1	Motor Mount - Grey
39	13073100008	8	NUT, HEX, FLANGED, Steel, Mild 1/2-13 UNC
40	13000007228-00	1	Engine - Kohler - Gas - 9.5 hp

Part #	Page	Ref #	Part #	Page	Ref #	Part #	Page	Ref #
13000007014-00	D2	1	13000005507-00	D4	3	13000005802-00	D5	31
13073902040	D2	2	13070204024	D4	4	13000007035-00	D5	32
13000001646-00	D2	3	13000006226-00	D4	5	13073500006	D5	33
13000006679-00	D2	4	13072900004	D4	6	13070206028	D5	34
13000006125-00	D2	5	13070206020	D4	7	13070206014	D5	35
13000006121-00	D2	6	13000005982-00	D4	8	13000007063-00	D5	36
13000006706-00	D2	7	13073000006	D4	9	13070206008	D5	37
13000005523-00	D2	8	13000005735-00	D4	10	13000007086-00	D5	38
13000006623-00	D2	9	13000005737-00	D4	11	13073100008	D5	39
13000007022-00	D2	10	13000007025-00	D4	12	13000007228-00	D5	40
13072500006	D2	11	13000005731-00	D4	13			
13073500006	D2	12	13000005732-00	D4	14			
13070204016	D2	13	13000005733-00	D4	15			
13073600004	D2	14	13000006779-00	D4	16			
13000005553-00	D2	15	13000001646-00	D4	17			
13070206020	D2	16	13073902040	D4	18			
13072500008	D2	17	13000006227-00	D4	19			
13072700008	D2	18	13000006727-00	D5	1			
13000006756-00	D2	19	13000007036-00	D5	2			
13000006739-00	D3	1	13073100008	D5	3			
13073000005	D3	2	13000005503-00	D5	4			
13070212080	D3	3	13070908032	D5	5			
13000001060-00	D3	4	13000006123-00	D5	6			
13000005665-00	D3	5	13070206096	D5	7			
13000007333-00	D3	6	13000005523-00	D5	8			
13000007059-00	D3	7	13000006084-00	D5	9			
13000007017-00	D3	8	13000006430-00	D5	10			
13000007121-00	D3	9	13073000006	D5	11			
13000005552-00	D3	10	13070206036	D5	12			
13070204014	D3	11	13070206040	D5	13			
13073000004	D3	12	13000007016-00	D5	14			
13070204016	D3	13	13070204012	D5	15			
13000006569-00	D3	14	13072500004	D5	16			
13000007618-00	D3	15	13000007054-00	D5	17			
13000007106-00	D3	16	13070704012	D5	18			
13000005667-00	D3	17	13000006756-00	D5	19			
13000007332-00	D3	18	13000007056-00	D5	20			
13000006756-00	D3	19	13000007230-00	D5	21			
13070205012	D3	20	13000007034-00	D5	22			
13000007058-00	D3	21	13000007280-00	D5	23			
13000007088-00	D3	22	13070204016	D5	24			
13070904012	D3	23	13073600004	D5	25			
13000006923-00	D3	24	13000007272-00	D5	26			
13000005537-00	D3	25	13000006791-00	D5	27			
13070204020	D3	26	13000007193-00	D5	28			
13000006756-00	D4	1	13000005567-00	D5	29			
13000005805-00	D4	2	13070204012	D5	30			

LIMITED WARRANTY STATEMENT

1. Meridian Manufacturing Inc warrants each new Meridian Manufacturing Inc product (the "Goods") to be free from defects in material and workmanship under normal use and service for a period of one (1) year or ninety (90) days in the case of commercial use, from the shipment date from the Meridian dealer (FCA).
2. Meridian warrants replacement parts and components either manufactured or sold by, will be free from defects in materials or workmanship under normal use and service for thirty (30) days from the shipment date from the Meridian dealer (FCA), or the remainder of the original warranty period on the Goods, whichever is longer.
3. This warranty does not apply to:
 - a) to any merchandise or components thereof, which in the sole and unfettered opinion of Meridian, have been subject to misuse, unauthorized modifications, alteration, accident, negligence, product abuse or lack of required maintenance.
 - b) if repairs have been made with parts or by persons other than those parts or persons approved by Meridian.
 - c) to parts and accessories not manufactured by Meridian including, but not limited to, engines, batteries, tires, belts, PTO shafts or other trade accessories. Such parts shall be covered by the warranty given by the actual manufacturer, if any.
 - d) to failure of parts; or failure of parts to perform due to wear under normal or excessive service conditions; or to failure due to use by the Purchaser for purposes other than originally intended at time of manufacture, including without limitation using the Goods for mixing fertilizer, canola, etc.; or used in excess of the built specifications.
 - e) to Goods used in areas exposed to corrosive or aggressive conditions including, but not limited to, salt water from either inside or outside the Goods.
 - f) to failures or defects arising out of damage during shipment or during storage.
 - g) to materials replaced or repaired under this warranty, except to the extent of the remainder of the applicable warranty.
4. The obligation of Meridian under this warranty shall not arise unless Meridian is notified and this warranty is presented together with a written statement specifying the claim or defect within thirty (30) days after the failure is first detected or made known to the Purchaser and within: (i) one (1) year, or ninety (90) days in the case of commercial use; or (ii) thirty (30) days in the case of replacement parts and components manufactured by Meridian; from the shipment date from the Meridian dealer (FCA). Meridian in its sole and unfettered discretion shall determine if the claim is valid and whether correction of the defect or failure shall be made by repair or replacement of the materials.
5. Title to any replaced materials Meridian wishes to have pass to it, shall pass to Meridian.
6. The obligation of Meridian hereunder extends only to the original Purchaser or Buyer to whom the Goods were initially sold. This warranty shall not be subject to any assignment or transfer without the written consent of Meridian.
7. The purchaser acknowledges that it has made its own independent decision to approve the use of the Goods and also the specific fabrication and construction procedures utilized to complete the Goods, and has satisfied itself as to the suitability of these products for its use.

WARRANTY

8. This warranty is subject to the following limitations, provisions and conditions:
 - a) Meridian shall have no liability hereunder for any claims, including field re-work.
 - b) Meridian shall not be liable for any incidental loss or damage, however caused, including, without limitation, normal wear and tear.
 - c) Meridian makes no express or implied warranties of any nature whatsoever except for such express warranties as set out herein. The warranty provided herein is in lieu of and excludes all other warranties, guarantees or conditions pertaining to the Goods, written or oral, statutory, express or implied, (except the warranty as to title) including any warranty as to the merchantability or fitness for any particular purpose. Meridian expressly disclaims all other representations, conditions or warranties, expressed or implied, statutory or otherwise and any representations, warranties or conditions that may arise from a course of dealing or usage of trade. The warranty provided herein shall constitute Meridian's sole obligation and liability and the Purchaser's sole remedy for breach of warranty. No other warranty has been made by any employee, agent, or representative of Meridian and any statements contained in any other printed material of Meridian is expressly excluded herefrom. Meridian shall not be responsible for any warranty offered by the Purchaser to its customers with respect to the Goods and the Purchaser shall indemnify Meridian with respect to same if any of those customers makes a claim against Meridian relating to any such warranty.
 - d) Subject to Meridian's obligations contained in paragraphs 1 and 2 herein, none of Meridian, its officers, directors, servants or agents shall be liable, or responsible for any loss or damage (including strict liability and liability for loss or damage due to items which the manufacturing processes are designed to identify) whether such loss or damage is caused by negligence in any manner whatsoever (including gross negligence, error, misrepresentation, misstatement, imprudence, lack of skill or lack of judgement).
9. The sole financial obligation of Meridian under this warranty shall be limited to the repair or replacement of the Goods as originally supplied and in no event shall they exceed the original cost of the Goods supplied.
10. Meridian shall not have any obligation under any warranty herein until all accounts have been paid in full by the Purchaser.
11. The construction and interpretation of this Warranty shall be governed by the laws of the Province of Saskatchewan.

Warranty Claim Procedure

1. Purchaser must register the Goods with Meridian.
2. Purchaser must contact the dealer where the unit was purchased from upon discovery of any defects.
3. A completed warranty claim form must be submitted by the dealer to Meridian's warranty representative for review and any subsequent course of action.
4. Warranty repair work will only be performed by Meridian or an approved representative of Meridian. No warranty work completed prior to approval by Meridian will be honored. Failure to follow procedure may affect any or all of this warranty.
5. Claims will be adjudicated at the sole discretion of Meridian and in accordance with the terms and conditions of the limited warranty.

MERIDIAN MANUFACTURING INC.

With over 65 years of experience,
Meridian is your storage and handling expert.



www.meridianmfg.com

Cambridge Office

605 Sheldon Dr.
Cambridge, On. N1T 2K1
PH: 519.620.6004
TF: 855.346.3712
FX: 519.620.6041

Camrose Office

4232 - 38 St.
Camrose, AB T4V 4B2
PH: 780.672.4516
TF: 800.830.2467
FX: 780.672.4759

Lethbridge Office

3125 - 24 Ave. N.
Lethbridge, AB T1H 5G2
PH: 403.320.7070
TF: 800.661.1436
FX: 403.320.7579

Regina Office

PO Box 1996
Regina, SK S4P 3E1
PH: 306.545.4044
TF: 800.667.5904
FX: 306.545.4216

Storm Lake Office

2902 Expansion Blvd.
Storm Lake, IA 50588
PH: 712.732.1780
TF: 800.437.2334
FX: 712.732.1028

Winkler Office

Box 760, 275 Hespler Ave.
Winkler, MB R6W 4A8
PH: 204.325.7883
TF: 800.665.7259
FX: 204.325.5556